

电动机外形及安装尺寸

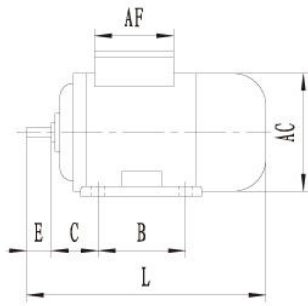

IM B3

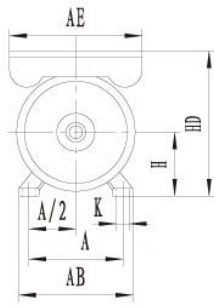

IM B5

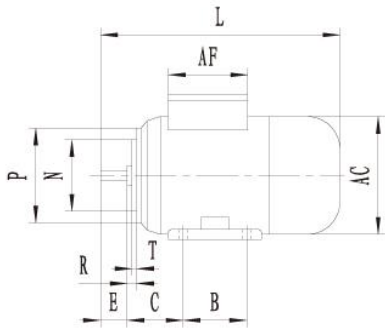
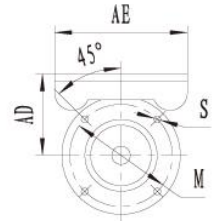
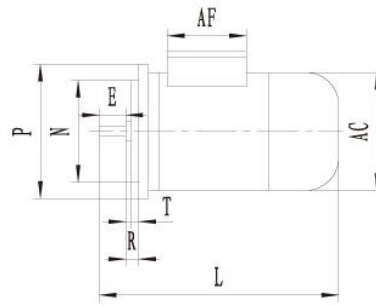

IM B34

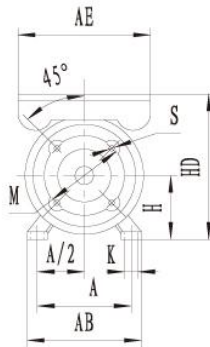

IM B14

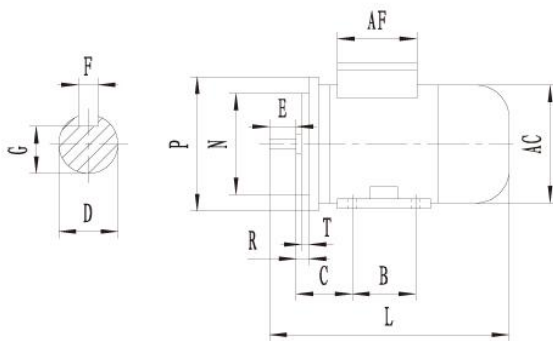
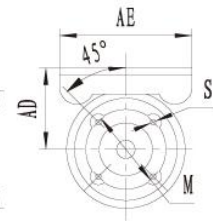
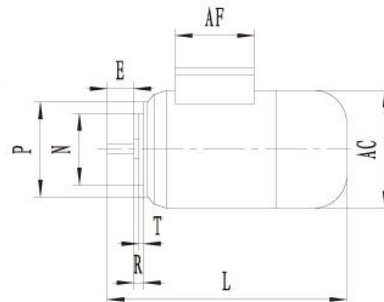

IM B35

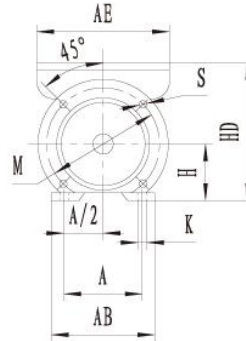

机座号 Frame size	安装尺寸 Mounting dimensions															外形尺寸 Outline dimensions				
	A	B	C	D	E	F	G	H	K	M	N	P	R	S	T	AB	AC	AD	HD	L
71	112	90	45	14	30	5	11	71	7	130	110	160	0	10	3.5	145	145	140	180	255
80	125	100	50	19	40	6	15.5	80	10	165	130	200	0	12	3.5	160	165	150	200	295
90S	140	100	56	24	50	8	20	90	10	165	130	200	0	12	3.5	180	185	160	240	370
90L	140	125	56	24	50	8	20	90	10	165	130	200	0	12	3.5	180	185	160	240	400
100L	160	140	63	28	60	8	24	100	12	215	180	250	0	15	4.0	205	220	180	260	430
112M	190	140	70	28	60	8	24	112	12	215	180	250	0	15	4.0	245	250	190	300	455
132S	216	140	89	38	80	10	33	132	12	265	230	300	0	15	4.0	280	290	210	350	525
132M	216	178	89	38	80	10	33	132	12	265	230	300	0	15	4.0	280	290	210	350	553

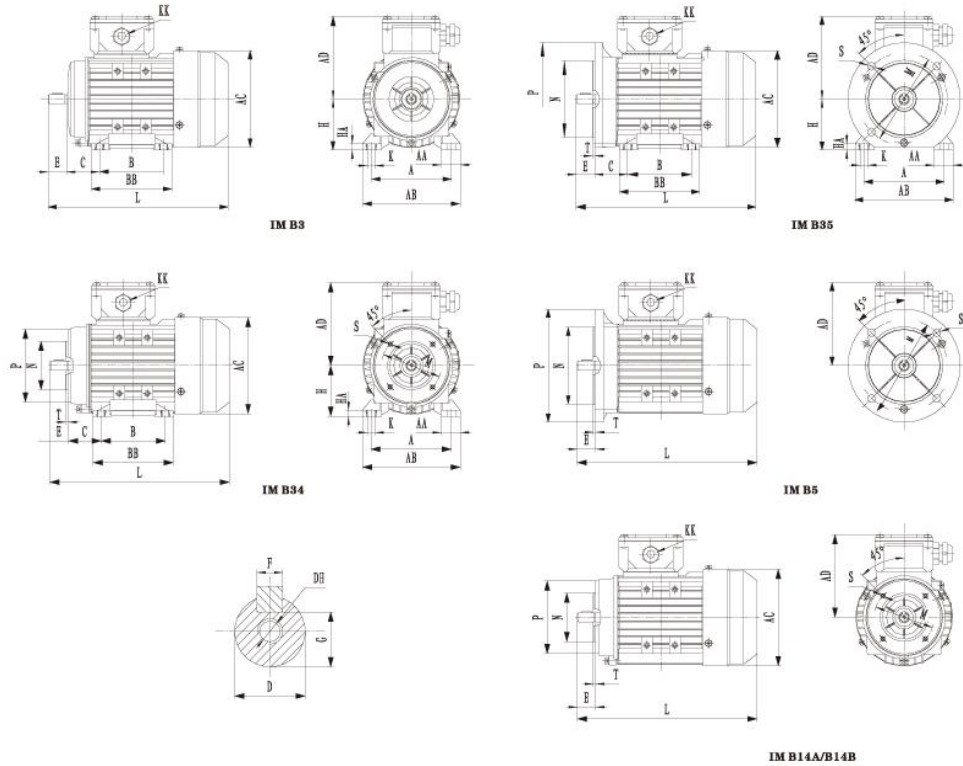

YE2-63~160 B3、B5、B35

机座号 Frame size	安装尺寸 Mounting dimensions																	外形尺寸 Outline dimensions						
	A	AA	AB	BB	HA	AC	AD	B	C	D	DH	E	F	G	H	K	KK		L	M	N	P	S	T
	METRIC		PG																					
YE2-63M	100	36	125	102	9	130	105	80	40	11	M4X10	23	4	8.5	63	7.0	1-M20×1.5	1-PG13.5	220	115	95	140	10	3
YE2-71M	112	40	140	115	10	145	115	90	45	14	M5X13	30	5	11.0	71	7.0	1-M20×1.5	1-PG13.5	250	130	110	160	10	3.5
YE2-80M	125	44	158	125	10	165	125	100	50	19	M6X16	40	6	15.5	80	10.0	1-M20×1.5	1-PG16	290	165	130	200	12	3.5
YE2-90S	140	50	175	130	12	185	135	100	56	24	M8X20	50	8	20.0	90	10.0	1-M20×1.5	1-PG16	315	165	130	200	12	3.5
YE2-90L	140	50	175	155	12	185	135	125	56	24	M8X20	50	8	20.0	90	10.0	1-M20×1.5	1-PG16	340	165	130	200	12	3.5
YE2-100L	160	54	200	175	13	205	155	140	63	28	M10X22	60	8	24.0	100	12.0	2-M20×1.5	2-PG16	380	215	180	250	14.5	4
YE2-112M	190	60	225	176	13	230	175	140	70	28	M10X22	60	8	24.0	112	12.0	2-M20×1.5	2-PG19	400	215	180	250	14.5	4
YE2-132S	216	65	255	185	16	270	190	140	89	38	M12X28	80	10	33.0	132	12.0	2-M20×1.5	2-PG19	470	265	230	300	14.5	4
YE2-132M	216	65	255	220	16	270	190	178	89	38	M12X28	80	10	33.0	132	12.0	2-M20×1.5	2-PG19	510	265	230	300	14.5	4
YE2-160M	254	55	302	259	18	330	245	210	108	42	M16X36	110	12	37.0	160	14.5	2-M30×1.5	2-PG29	625	300	250	350	18.5	5
YE2-160L	254	55	302	303	18	330	245	254	108	42	M16X36	110	12	37.0	160	14.5	2-M30×1.5	2-PG29	670	300	250	350	18.5	5

YE2-63~160 B14A、B14B

机座号 Frame size	安装尺寸 Mounting dimensions									B14A						B14B				
	AC	AD	D	DH	E	F	G	KK		L	M	N	P	S	T	M	N	P	S	T
	METRIC		PG																	
YE2-63M	130	105	11	M4×10	23	4	8.5	1-M20×1.5	1-PG13.5	220	75	60	90	M5	3	100	80	120	M6	2.5
YE2-71M	145	115	14	M5×13	30	5	11.0	1-M20×1.5	1-PG13.5	250	85	70	105	M6	3	115	95	140	M8	3
YE2-80M	165	125	19	M6×16	40	6	15.5	1-M20×1.5	1-PG16	290	100	80	120	M6	3	130	110	160	M8	3.5
YE2-90S	185	135	24	M8×20	50	8	20.0	1-M20×1.5	1-PG16	315	115	95	140	M8	3	130	110	160	M8	3.5
YE2-90L	185	135	24	M8×20	50	8	20.0	1-M20×1.5	1-PG16	340	115	95	140	M8	3	130	110	160	M8	3.5
YE2-100L	205	155	28	M10×22	60	8	24.0	2-M20×1.5	2-PG16	380	130	110	160	M8	4	165	130	200	M10	3.5
YE2-112M	230	175	28	M10×22	60	8	24.0	2-M20×1.5	2-PG19	400	130	110	160	M8	4	165	130	200	M10	3.5
YE2-132S	270	190	38	M12×28	80	10	33.0	2-M20×1.5	2-PG19	470	165	130	200	M10	4	215	180	250	M12	4
YE2-132M	270	190	38	M12×28	80	10	33.0	2-M20×1.5	2-PG19	510	165	130	200	M10	4	215	180	250	M12	4
YE2-160M	330	245	42	M16×36	110	12	37.0	2-M30×1.5	2-PG29	625	215	180	250	M12	5	265	230	300	M14	5
YE2-160L	330	245	42	M16×36	110	12	37.0	2-M30×1.5	2-PG29	670	215	180	250	M12	5	265	230	300	M14	5